

Middle East PORTFOLIO

Architecture, Master Planning and Interiors



Who we are

DLR Group is a global architecture, interiors, engineering, and technology design firm with more than 1,600+ employee-owners in 33 Offices around the world.

DLR Group offers comprehensive services and specialized expertise.

Our team of designers has delivered many architectural design renovations and new build projects. We understand the complicated scopes and the aggressive schedules they need to have in order to be delivered and begin gaining the return on your investment. Every project has a strong vision and DLR Group can help you realize this.

Our team constantly seeks to bring high design ideas and concepts with a high level understanding of practical operational or durable solutions. We understand how important it is to have a project delivered on-time and under budget. Our team of designers has a vast portfolio of experience and an understanding for what needs to be done in order to provide ideal experience. Seamless coordination between all members of the team allows your project to be a priority and delivered on time without delay.



1600+

Employee-
Owners



1966

Year
Established



33

Offices
Worldwide





James P. Roubal

William L. Larson

Irving R. Dana

Founded in **1966**

As a multi-disciplinary firm with the shared ideals of quality, fairness, opportunity for growth, and ownership.

Architects Irv Dana and Bill Larson, and engineer Jim Roubal, launched their eponymous firm on April 1, 1966 from a 12-by-12-foot space in a basement at 102nd and Wright in Omaha. The integrated practice was founded on their shared ideals of quality, fairness, opportunity for professional growth, and ownership. Those principles drive our core values today.

The brands we partner with strategically drop into new locations to serve their markets and adapt to guest preferences. From New York to Los Angeles – and everywhere in between – DLR Group responds with a no boundaries model.

Our 33 studios across the globe provide local roots and familiarity with climate, market conditions, and jurisdictional regulations. From these hubs, we've delivered hospitality experiences in 38 states and counting.



Good Ideas Travel Well

FROM OUR STUDIOS
TO ANYWHERE.



We are designers and
100% EMPLOYEE-OWNED

*Our promise is
to elevate the
human experience
through design.*

This inspires a culture of design thinking and fuels the work we do around the world. We are 100 percent employee-owned: every employee is literally invested in our clients' success. Our teams champion true collaboration, open information sharing, shared risk and reward, value-based decision making, and proficient use of technology to elevate design.

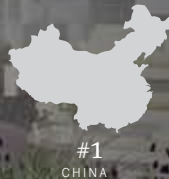
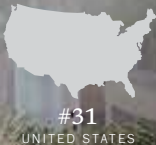

INTERGRATED

Market Sectors

Civic
Culture+Performing Arts
Federal
Healthcare
Higher Education
Hospitality & Residential
Justice
K-12 Education
Mixed-Use
Sports
Transportation
Workplace





Services of *Integrated Design*

Our teams champion true collaboration, open information-sharing, value-based decision-making, proficient use of technology from project outset to close out, and continuous monitoring to optimize a building’s performance to further our practice of evidence-based design.

Services

Our integrated design teams of multidisciplinary design professionals bring highly specialized expertise to every project.

01 Architecture

Equal parts art and science, architecture contributes value to the culture, history, and societies we live in and has the power to reshape the world for an inclusive, sustainable future for our communities.

02 Interiors

Interior design enhances brand, culture, and quality of life by leveraging industry and proprietary research to guide evidence-based design. This integrated approach to design enhances knowledge sharing and nurtures innovation.

03 Masterplanning

An effective master plan – be it for an entire campus, energy, facilities, an open space, or the urban core – delivers place-making, resilience, and ultimately, return on investment for communities, institutions, and owners.

04 Landscape

See projects, ideas, firm news, and awards that exemplify how landscape architecture contributes to our integrated design practice. The use technology, materials, and a site’s natural characteristics to enhance the built environment and reconnect people to the natural world.

-
- | | |
|-------------------------------|------------------------|
| » Architecture | » Lighting Design |
| » Interiors | » Preservation |
| » Landscape | » Reality Capture |
| » Master Planning | » Science + Technology |
| » Acoustical Design | » Sustainability |
| » Experiential Graphic Design | » Theater Design |
| » High Performance Design | |

Sustainability

MEETING THE CLIMATE CHANGE

Today, more than ever, it is essential to deliver sustainable designs with effective client-focused outcomes that exponentially impact our people, our communities, and our planet. Imagine a world where considerations about the built environment include behavioural awareness, resource conservation, human health, community health, and even our ecological future.

We Specialize In Guest Experiences

As a design firm, we live out our core value of environmental stewardship through building design and planning solutions. Thinking bigger and further in 2024 about sustainability starts with holding ourselves accountable. This is the reason we commit to work that aligns with goals of the industry including the Architecture 2030 Challenge, the China Accord the A&D Material Pledge, the SE2050 Challenge, and MEP 2040. More than just thoughts on paper, it's the way we do business as we help clients achieve their energy, environmental, and ESG goals. In addition, in 2023 we signed the Urban Land Institutes's Commitment to Health and Equity in the Built Environment.

Our sustainable designs in 2023 translated into water, energy, and environmental savings in these ways:



479,000

Homes Powered
in One Year



846,000

Passenger Vehicles
Removed from Roads



4,531,000

Acres of
Forest

RAISE THE BAR

The average reduction target of predicted energy use for qualifying projects of the DLR Group design portfolio with performance data has consistently exceeded the national peer group average. In FY23, our integrated designs generated a 50 percent energy reduction compared to average buildings.*

*GHG emissions are estimated using national average fuel ratio for energy use in buildings and EPA's Power Profiler Tool.

Our Firm in the Middle East

DLR Group is a global, integrated design firm with a strong presence in the Middle East through its office in Dubai. The Dubai office serves as the regional hub, enabling the firm to address the unique design challenges and opportunities within the Middle East.

At the heart of DLR Group's operations in Dubai lies a dedication to providing innovative and sustainable solutions that respond to both cultural and environmental needs. The firm's services encompass architecture, interiors, and planning, all of which are tailored to meet the evolving needs of clients and communities in the region.

DLR Group's architectural team in Dubai focuses on creating iconic, functional, and sustainable spaces in alignment with the vision of their clients. The Interior design services prioritize the creation of environments focused on improving well-being and productivity, while considering the specific cultural and aesthetic preferences of the Middle East. The planning services offered by DLR Group address the urgent urban and regional planning needs of growing cities in the region.

DLR Group's Dubai office has been involved in a wide range of high-profile projects across various sectors, including commercial developments, cultural institutions, educational facilities, hospitality, and residential complexes. The firm uses technology and innovative design methodologies to create spaces, ensuring they are not only functional but also future-proof.

DLR Group integrates local traditions, values, and aesthetics into its designs, ensuring each project resonates with the community it serves and fosters a deeper connection between the built environment and its users.

While DLR Group operates on a global scale, the Dubai office embodies the firm's commitment to local expertise. The team of professionals at the Dubai office understands the regional market, regulations, and cultural nuances, allowing DLR Group to offer tailored solutions that are both globally informed and locally relevant.

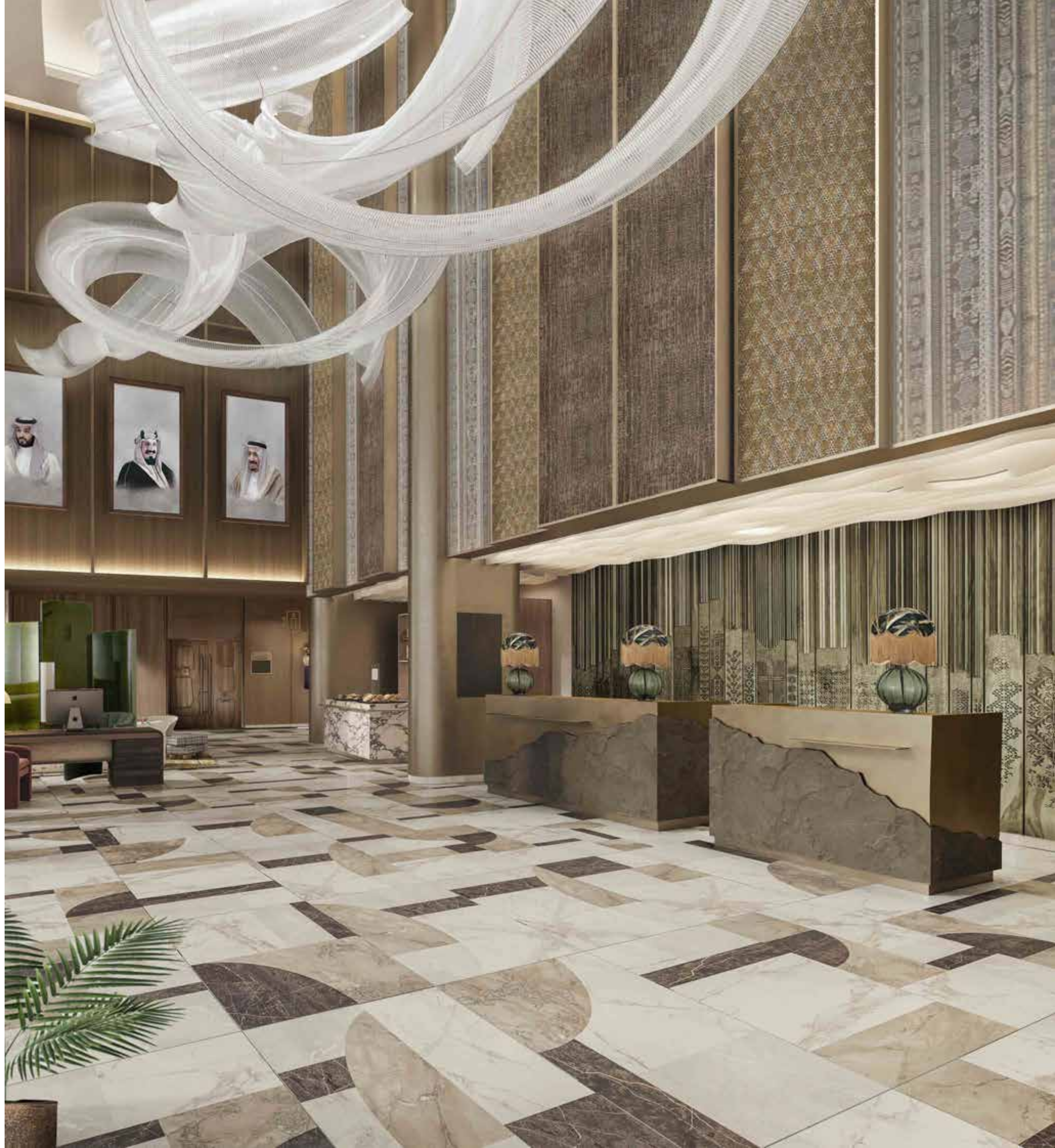

10+ EMPLOYEES

DLR Group Middle East officially opened its Dubai office in Dubai Design District (d3) on September 7, 2016.

New Leadership

December of 2017 is the beginning of the new leadership in DLR Group Middle East. With a wealth of valuable contacts and connections, **Jamal Salem** joined DLR Group as a Middle East Region Director. Jamal is responsible for design and client services throughout the Middle East, leading operations from the DLR Group Dubai office.

4+ EMPLOYEES

The beginning

It all started around 2013, when the firm got the opportunity to design the Mall of the Emirates Expansion project, thanks to Andrew Feola, the original designer of the mall. Mark Giles, who was already in Dubai connecting with a range of developers, clients, influential figures, and consultants in the region, was involved in the discussions. The client requested that DLR Group send a representative to Dubai to oversee the construction process. Edgar Bove volunteered, packed his bags, and headed to Dubai to take on the role.

10+ EMPLOYEES

As the leader of the technical design and development team, **Rupali**'s primary focus is to implement the company's core values. The main focal point being the delivery of high value design projects across all client requirements.

18+ EMPLOYEES

We think
GLOBAL
and be
LOCAL

Scott assumed the role of Mixed-Use Director, tasked with overseeing design projects within the Dubai office. Scott brings a unique and tested project approach with strong leadership and effective communication skills to successfully realize projects.



We have successfully delivered a substantial portfolio of mixed-use projects, creating a product that is only surpassed by the satisfaction of our clients and partners.

SEDCO
DEVELOPMENT

سدكو
للتنمية

ردسي
موس
RED SEA
MALL

EHTERAF

Midrar
مدرار

مدن
Modon

شركة راشد سعد الراشد وأولاده المحدودة
Rashid S. Al Rashid & Sons Co. Ltd

LEAD

Jubail Island
Investment Company

مدينة المعرفة الاقتصادية
Knowledge Economic City



Balubaid
Manufacturing

أزاد العقارية
AZAD PROPERTIES

McARTHUR+COMPANY
SHOPPING CENTRE SPECIALISTS

etisalat

SODIC

الشؤون الخاصة بالأمير
CROWN PRINCE PRIVATE AFFAIRS

IKEA®

DUBAI
HOLDING

EMAAR

VIVA
CITY

ماجد الفطيم
MAJID AL FUTTAIM

سمو
SUMOU

بنیان السعودية
Saudi Bonyān
Real Estate Investment - الإستثمار العقاري

AWJ

ثقات
Tharwat for Financial Securities

أبوداود
ABUDAWOOD

Hines

TRIPLE FIVE®
WORLDWIDE GROUP
555

Google

رؤك المدينة القابضة
Rua Al Madinah Holding

HYATT

Hilton

BOEING

*Partnerships
Power Passion*

TRUST. RELIABILITY. CREATIVITY.



MENA Experience

GLOBAL EXPERTISE ENRICHING
LOCAL COMMUNITIES.

We are a global firm with local reach. DLR Group operates with a business structure and a culture of interoffice workload sharing. The people with whom you work are directly backed by the firm's entire resources, enabling us to immediately and effectively scale our teams to meet your needs. This local connection translates to design solutions that are particularly relevant to climate, culture, and market conditions.



Envisioned as a Contemporary Lifestyle

Ehteraf Thumamah - Plot A
Jeddah, Kingdom of Saudi Arabia
Ehteraf Development

Strategically located on the intersection of Thumamah and Sahaba road, in Munisaya district, Riyadh, with a total area of 169,000 sqm Thumamah development is a mixed used development was envisioned as a contemporary lifestyle corner incorporating iconic urban shopping and entertainment for both residents and visitors alike. In our approach to developing the concept we sought to maximize the views of the retail block, while capturing the experience on Thumamah. The retail component features interiors that pay homage to the distinct culture of the region incorporating imagery, materials, and patterns that all evoke Saudi heritage while offering generous spaces and views.

The overall mixed-use project is approximately 169,000 sqm. The remaining 120,000 sqm of land will be integrated with the IKEA store 85,000 sqm and tie into create one integrated mixed- use destination with a mix of retail and F&B outlets around activated and beautifully landscaped outdoor areas.

Completed: On the Drawing Board
Size: GLA - 70,007 sqm / GLA IKEA + PLOT A 97,735 sqm
Project Value: Confidential
Services: Architecture, Interior Design, and Lead Consultancy





Iconic

Lulu

COSTA

COSTA

THUMAMAH

IMAX
THEATRE



Earthy Essence

Ehteraf Thumamah Serviced Residences
Thumamah, Kingdom of Saudi Arabia
Ehteraf Development

Inspired by an earthy color palette with a neutral base, a homey design approach with the use of light materials and fresh accents has been achieved within the development of this boutique suite design, as part of a serviced residential project.

A balance between contemporary and minimal design is incorporated to emphasize an elevated experience within a comfortable space.

Status: On the drawing board
Year Designed: 2022
Size: N/A
Number of Keys: N/A
Project Value: Confidential
Services: Planning, Architecture, and Interior Design



Connecting Cultures from all Around the World

Hijaz Mall
Makkah, Kingdom of Saudi Arabia
Aswaq Al Hijaz Trading Company

Completed: On the Drawing Board
Size: 300,000 SQM
Project Value: \$373,140,000
Services: Planning, Architecture,
and Interior Design



The goal of Al Hijaz was to create a new retail and hospitality destination for the community and the pilgrims connecting cultures from all around the world in a single experience. The street level is enriched by its reference to nature while the journey inside the development is likened to the organic movement and physical formations of the wadi with winding turns walled in by monumental vertical formations. At the same time the different programs within the development are bridged together seamlessly in a design that does not only focus on connectivity but also on urban interaction.

The project comprises over 36,000sqm of retail supporting over 300,000 sqm of living space. They comprise 34,500 sqm of hotel space consisting of 575 keys, 24600 sqm of secondary housing consisting of 240 units, and over 250,000 sqm of pilgrim housing consisting of around 5,200 units. In total this program required 1,915 parking spaces to support it.



A contemporary lifestyle quarter for Iconic urban shopping

Mall of Medina
Madinah, Kingdom of Saudi Arabia

The overall design intent considers a signature design specific to Al-Othaim with an elevated brand identity which will stand out as a special offering, with a one-of-a-kind mix that is unique to the region.

The design considers family entertainment offers including: Fabyland, Saffori Land, Splash, Snow City, My town, and Action zone. We have combined these concepts to help anchor the project in order to activate all retail areas.

Status: Concept stage
Size: 206,620 sqm
Project Value: Confidential
Services: Planning, and Architecture



Cultural Heritage

Aseer Front Mixed-Use Development
Khamis Mushait, KSA
Ehteraf Development

The project is located in Khamis Mushait a Saudi City of touristic and commercial significance. Aseer Front explores opportunities for a 4.7 KM walkaway strip as a point of rest, hiking and entertainment activating the avenue with a range of new facilities and integrating a future mall 'Salman Avenue' to this community park.

The cultural heritage of Saudi Arabia is unique as it has remained mostly unaltered. The urban function of the Aseer Front has changed from the urban channel to the living avenue with landscape and public activities. The overall mixed use project is approximately 1,420,800 SF of Commercial, Retail, F&B, Entertainment, Hotel.



Completed: On The Drawing Board
Size: 1,420,836 SF
Project Value: \$60,000,000
Services: Architecture and Planning





A Lifestyle Destination

Madinah Commercial Complex
Khamis Mushait, Kingdom of Saudi Arabia
Ehteraf Development

A new lifestyle destination in the religious city of Madinah, Saudi Arabia, features retail, entertainment, and hospitality elements. It will be built southwest of the Knowledge Economic City development along Al Hijrah Road and next to the High-Speed Rail southbound line crossing. DLR Group's design creates a contemporary lifestyle quarter with specialty retail outlets, a hypermarket, a cinema, entertainment venues, boutique suites, and an IKEA outlet, which is a staple of the Ehteraf development. The ambition of the project builds on Ehteraf's brand promise, to activate this new location within Madinah to be truly a 24-hour development, linked with an array of shopping, entertainment and living. This destination features key elements such as a central plaza, which is the main arrival point to the development. It is designed to be a well-designed public realm that serves as a gathering space for visitors. The plaza is accessible from all the development components and offers a powerful entertainment venue for the family. It can host laser display shows, design, and cultural events, and even auto expos offering an open urban plaza that enhances pedestrian footfall. Other key elements include an F&B icon and a well-designed public realm, all designed to create a well-balanced destination that offers a new lifestyle experience for the community and visitors.



Completed: On The Drawing Board
Size: 731,945 SF
Project Value: Confidential
Services: Architecture and Interior Design

By Sector

See All Work

<https://www.dlrgroup.com/>



Civic

We focus on design that efficiently connects citizens to public services at the city, county, state, and federal levels, increasing their engagement with the government while improving the workplace experience for employees.



Cultural+Performing Arts

Our expertise extends to the following program types: theaters and performance venues of all kinds; museums and galleries; media and broadcast-related projects; and instructional and studio spaces for music, dance, drama, and the visual arts.



Federal

Delivering secure and resilient buildings for the well-being of individuals and agencies, today and tomorrow, at home and abroad.



Healthcare

See projects, ideas, and press that shows how our evidence-based design considers the emotional, mental, and social wellbeing of its inhabitants to root our practice in empathy.



Higher Education

We fully embrace our responsibility to society by designing spaces that emphasize academic learning and social development.



Hospitality

We use a collaborative approach to understand a local community and then curate a project vision that aligns client goals and the brand personality of a hotel within that local environment.



Justice

Our courts designs balance the dignified delivery of justice with the individual's perception and experience of the courthouse as a safe, welcoming, and accessible facility for society.



K-12 Education

We help districts across the country navigate this change to better serve educators and communities, and improve educational experiences and outcomes for students.



Mixed-Use

We bridge enterprise and community through transformative design that enlivens social hubs, curates distinctive stories, and creates cultural identity.



Sports

We design facilities to attract and retain top coaches, recruit and develop the best athletes, and create memorable experiences for modern-day fans.



Transportation

We design transit facilities to connect citizens to their cities, counties, and the world beyond, bringing users along for a pleasant ride.



Workplace

The power of design shapes environments that celebrate people at work: inspiring lifestyles of limitless thinking, growth, and wellbeing.



“

I believe DLR Group is the best integrated design firm in the world, and I am honored to lead our employee-owned firm as CEO.”

—
Steven McKay, RIBA
CEO, Managing Principal

Achievements

a leading firm

Our promise is to elevate the human experience through design. This inspires a culture of design and fuels the work we do around the world. We are 100 percent employee -owned and aspire to be the most creative enterprise on the planet.

Rankings

<div>#9</div> <div>Global Design Firm</div> <div>BD World Architecture 100</div>	<div>#13</div> <div>Architectural Record Top U.S. Firms</div> <div>Architectural Record Top U.S. Firms</div>	<div>#7</div> <div>Architecture/ Engineering Firm</div> <div>Building Design + Construction</div>	<div>#15</div> <div>Interior Design Firm</div> <div>Interior Design – Top 100 Giants</div>	<div>#20</div> <div>Design Firm</div> <div>Engineering News Record</div>	<div>#2</div> <div>K-12 School Design Firm</div> <div>Building Design + Construction</div>
--	--	---	--	--	--

BD World Architecture 100 - #9 Global Design Firm; #1 Government Design Firm; #2 Cultural Design Firm; #2 Education Design Firm; #7 Hospitality Design Firm; #8 Office Design Firm; #4 Engineering Firm; #6 Interior Design Firm; #9 Architecture Firm, Architectural Record Top U.S. Firms - #13. Building Design + Construction - #7 Architecture/Engineering Firm; #2 K-12 School Design Firm; #2 Public Safety Design Firm; #2 Cultural Design Firm; #9 Higher Education Design Firm; #10 Workplace Interiors; #10 Reconstruction Design Firm; #12 Retail Design Firm; #13 Hospitality Design Firm; #13 Office Design Firm, Interior Design - Top 100 Giants - #15 Interior Design Firm, Engineering News Record - #20 Design Firm; #2 Cultural Design Firm; #3 Education Design Firm; #3 Justice Design Firm; #14 Hospitality Design Firm; #15 Mixed-Use Design Firm; #15 Workplace Design Firm

An award winning firm...

Recent Awards & Recognitions

Middle East Awards



2024

CID Awards - Hospitality

Finalist - Canopy Central
Best F&B Design Concept
Finalist - Hilton The Point
Best Hotel Design Concept
Finalist - Hospitality Design Firm of the Year
Finalist - Vaida Buchrotaite
Hospitality Designer of the Year

Architecture Leaders Awards

Winner - KEC Masterplan
Masterplan of the Year
Highly Commended – Commercial Project
of the Year - Future City Sales Center
Finalist - Architecture Firm of the Year
Finalist - Hospitality Project Design (F&B)
Canopy Central

Design Middle East Awards - KSA

Highly Commended - Architecture Firm of
the Year
Winner - Henrique Dias
Architect of the Year
Finalist - Isolina Mahmoud
Young Talent of the Year
Finalist - Vaida Buchrotaite
Interior Designer of the Year
Finalist - Scott Pryde
Architect of the Year
Finalist - Interior Design Firm of the Year
Finalist - The Point, Abha - Best Future
Projects of the Year
Finalist - Rashid Mall
Best Future Project
Finalist - Buruj Hotel
Best Concept
Finalist - Knowledge Economic City
Master Plan of the Year

International Property Awards

Winner - Lavida Residences
Best International Residential High Rise
Architecture

CID Awards - Saudi

Finalist - Abha Hilton Services Apartments
Best Interior Design Concept of the Year,
Hospitality
Finalist - Multaka Residences
Best Interior Design Concept of the Year,
Residential.
Winner - Kinjal Porecha
Unsung Hero of the Year
Finalist - Shiam Shibl
Young Interior Designer of the Year
Finalist - Vaida Buchrotaite
Interior Designer of the Year
Finalist - Interior Design Firm of the Year

2023

Design Middle East Awards

Winner - Boris Lam
Project Manager of the Year
Winner - Shiam Shibl
Emerging Interior Designer of the Year
Finalist - Vaida Buchrotaite
Interior Designer of the Year
Finalist - Rupali Pote
Architect of the Year
Finalist - Marco Gaudio
Landscape Architect of the Year
Finalist - Best Workplace of the Year
Finalist - Architecture Firm of the Year
Finalist - Interior Design Firm of the Year
Finalist - The Point, Abha
Best Future Projects of the Year
Finalist - Lavida Development
Best Future Projects of the Year
Finalist - Knowledge Economic City Master
Plan of the Year

Identity Design Awards

Finalist - Buruj Hotel - Hotel
Finalist - Shiam Shibl - Emerging Interior
Designer of the Year
Finalist - The Point Abha - Commercial

International Property Awards - Arabia

Winner - Buruj Hotel
Hotel Architecture Award
Winner - Lavida Residences
Residential High-Rise Architecture Award
Winner - The Point Abha
Mixed-Use Architecture Award

CID Awards - MENA

Finalist - The Point, Canopy Hotel Abha Best
Interior Design Concept of the Year, Hotel &
Residential
Finalist - Interior Design Firm of the Year
Finalist - Best Architectural Firm of the Year
Finalist - Vaida Buchrotaite
Interior Designer of the Year
Finalist - Tijana Cirikovacki
Project Manager of the Year
Finalist - Kinjal Porecha
Unsung Hero of the Year

CID Awards - Hospitality

Winner - Abha Canopy Hotel (by Hilton) Best
Hotel Design Concept
Finalist - Hospitality Design Firm of the Year
Finalist - Vaida Buchrotaite
Hospitality Designer of the Year
Finalist - Henrique Dias
Hospitality Designer of the Year

CID Awards - Saudi

Highly Commended - Abha, The Point
Interior Design of the Year Concept
Finalist - Pioneering Design Firm of the Year
(Editor`s Choice)
Finalist - Vaida Buchrotaite
Interior Designer of the Year
Finalist - Interior Design Firm of the Year

Global RLI Awards

Winner - RLI Designer of the Year
Highly Commended - The Point, Abha
RLI Future Project

Architecture Leaders Awards

Finalist - Architecture firm of the Year
Finalist - Best Workplace of the Year
Finalist - Abha Mixed-use Development
Finalist - Lavida Development Best Future
Projects of the Year
Winner - Dr. Essam Nabih
Lifetime Achievement Award
Highly Commended - Henrique Dias
Architect of the Year
Finalist - Kirby Zalameda
Architect of the Year
Finalist - Isolina Mahmoud
Young Talent of the Year

2022

Construction Week Awards

Finalist - Architecture Firm of the Year
Finalist - Sport Society
Commercial Project of the Year
Finalist - Vaida Buchrotaite
Female Leader of the Year

Middle East Consultant Awards

Winner - Company of the Year
Finalist - Architecture Firm of the Year
Finalist - Interior Design Firm of the Year

Design ME Awards

Winner - Interior Design Firm of the Year
Highly Commended - Buruj Hotel
Best Future Project
Finalist - Architecture firm of the Year
Finalist - Best Workplace of the Year
Finalist - Henrique Dias
Architect of the Year
Finalist - Vaida Buchrotaite
Interior Designer of the Year
Finalist - Dr. Essam Nabih
Lifetime Achievement of the Year
Finalist - Isolina Mahmoud
Young Talent of the Year

Architecture Leaders Awards

Winner - Sport Society
Commercial Project of the Year
Winner - Jamal Salem
Lifetime Achievement Award
Highly Commended - Jubail Island
Best Future Project of the Year
Finalist - Architecture Firm of the Year
Finalist - Best Workplace of the Year
Finalist - Scott Pryde
Architect of the Year
Finalist - Naji Safi
Young Talent of the Year

Index Design Awards

Winner - Laura Lee
Rising Star of the Year
Finalist - Jubail Beach Club
Concept Design of the Year
Finalist - Interior Design Company of the
Year
Finalist - Vaida Buchrotaite
Interior Design Leader of the Year

The Big-5 Construction Impact Awards

Finalist - Jubail Island
Community of the Future

CID Awards

Finalist - Interior Design Firm of the Year
Winner - Laura Lee
Young Interior Designer of the Year
Finalist - Sultan Street
Interior Design Concept of the Year
Finalist - Vaida Buchrotaite
Interior Designer of the Year
Finalist - Sherwin Boston
Behind the Scenes Award





Previous Awards & Recognitions

2021

Design ME Awards

Winner - Islamic World District (IWD) Master Plan of the Year
Finalist - Architecture Firm of the Year
Finalist - Interior Design Firm of the Year
Finalist - Sport Society Retail Project of the Year
Finalist - Jubail Island Best Future Project
Finalist - Jamal Salem Lifetime Achievement
Finalist - Stephanie Kinnick Project Manager of the Year
Finalist - Vaida Buchrotaite Interior Designer of the Year
Finalist - Naji Safi Young Talent of the Year

Arabian Property Awards

Winner - Jubail Island Best Mixed-use Architecture
Winner - Jubail Island Best Mixed-use Architecture - Abu Dhabi
Winner - Madinah Gate Best Mixed-use Architecture - Saudi Arabia
Architecture Leaders Awards
Winner - Emerging Architecture Firm of the Year
Construction Week Awards
Finalist - Architecture Firm of the Year
CID Awards
Finalist - Interior Design Firm of the Year
identity Awards
Finalist - Jubail Island Best Future Project

2020

Honorable Mention - Fujairah Fine Arts Academy - Unbuilt
AIA Cleveland
Winner - Sport Society - Leisure Architecture Dubai
International Property Awards

2017

Winner - Mall of the Emirates Expansion Shopping Centre Renovation Award
Retail & Leisure Institute (RLI)

2016

Winner - Mall of the Emirates Expansion Design and Development Excellence Gold Award
International Council of Shopping Centers (ICSC)
Middle East Council of Shopping Centers (MECSC)



Awards are nice but the real reward is the respect and appreciation of our work from our client user groups, professional organizations and design peers.



Global Awards

2024

ICSC Global Awards - Global Design & Development

Finalist - The Point, Abha
Evolving Innovation & Aspiration

ABC Carolinas Excellence in Construction Awards

Eagle and Merit Awards - The Healthcare Construction Over 50M
UNC Health Blue Ridge Valdese Cancer Center

Eagle and Merit Awards - Renovations/Restorations \$5M-\$10M
Catawba College Center for the Environment

ASHRAE

Winner - 311 W Monroe
1st place from the Chicago Chapter of ASHRAE RES Americas - Merit Award

IIDA Rocky Mountain Chapter's annual Best Awards

Best of the Best - Swarthmore College Dining and Community Commons

Best Award - Swarthmore College Dining and Community Commons Food & Drink Category

Merit Award - RES Americas - Workplace 25k-40Ksf category

Peoples Choice - Catbird Prototype Loft Bed

2023

Muse Hotel Awards

Winner - Thompson Denver
World-Class Lifestyle Boutique Hotel

ACI Excellence in Concrete Award

Winner - Thompson Denver
Commercial/Industrial Buildings

Travel and Leisure

Finalist - Scarlet Hotel Lincoln
One of the best new hotels in a college town

2022

NEWH Top Interior Design Firm

Winner - Top Interior Design Firm

AIA Nebraska - Excellence in Design Awards

Architectural Honor Award - UNMC Voigtman

Distinguished Accomplishment in Unbuilt Architecture

Architectural Citation Award - Conagra
Distinguished Accomplishment in Unbuilt Architecture

Previous Awards & Recognitions

2021

41st annual Gold Key Awards for Excellence in Hospitality Design

Winner - Designer of the Year

Best New Hotels in the World Travel & Leisure

Finalist - Surety Hotel - Aparium
Best Lobby Upscale, Best Guestroom Upscale, and Hotel Upper Midscale

Boutique Design Magazine

Gold Key Award - Surety Hotel
Aparium, Best Guestroom Upscale

Muse Design Awards

Platinum - Surety Hotel
Aparium Historic Restoration
Platinum - Surety Hotel - Aparium Renovation
Gold - Surety Hotel - Aparium Hotels & Resorts
Gold - Surety Hotel - Aparium - Hospitality

Boutique Design Magazine

Gold Key Award - Surety Hotel
Aparium, Best Guestroom Upscale

Travel & Leisure Best New Hotels in the World List

Surety Hotel - Aparium

AIA Nebraska

Merit Award - Surety Hotel - Aparium
Interior Architecture

Muse Design Awards

Platinum - Kimpton Cottonwood Hotel Renovation

Gold - Kimpton Cottonwood Hotel

Historic Restoration

Gold - Kimpton Cottonwood Hotel - Hotels & Resorts

Gold - Kimpton Cottonwood Hotel Hospitality

Boutique Design Magazine

Gold Key Award - Kimpton Cottonwood Hotel
Best Lobby Upscale

Gold Key Award - Kimpton Cottonwood Hotel
Judges' "So Cool"

AIA Nebraska

People's Choice - Kimpton Cottonwood Hotel
Excellence in Interior Architecture

41st annual Gold Key Awards for Excellence in Hospitality Design

Finalist - AC Hotel Scottsdale
Best Hotel Focused Service

Hotel Hot List Hospitality Design Magazine

Winner - Thompson Denver Hotel

Wood Design & Building Magazine's

Canadian Wood Council Award

Winner - Hines T3 West Midtown



ELEVATE *the*
HUMAN EXPERIENCE
THROUGH DESIGN

 **DLR**GROUP

DSP Towers - South, Level 16
Al Barsha South 2, Dubai Science Park
Dubai, United Arab Emirates
Tel. No. +971 4 568 7742