



International Architecture Platform of Australia



IAPA DESIGN

IAPA DESIGN is an international design firm established in 1998. The firm is led by an experienced team of architects from Australia and around the world. IAPA's main office is located in Sydney, Australia, with an operational office in Guangzhou, China. IAPA is well practiced in a wide range of design disciplines, including urban design, architectural, landscape, and interior design.

IAPA has attracted exceptional design talent from around the world thanks to its modern cutting-edge international design philosophy and excellent reputation within the industry. Our unique mix of talent is what enables IAPA to design with international expertise and local sensibility. These exceptional designers from Australia, Europe, Asia, the Americas, and the Middle East form IAPA's distinctive, multidisciplinary, and multicultural design team.

With outstanding creative capabilities and over 20 years of accumulated experience, IAPA have successfully completed hundreds of exceptional projects. These projects encompass a wide range of disciplines, including comprehensive planning and design for urban core areas, waterfront districts, urban parks, scenic areas, residential communities, heritage preservation, and creative industrial parks. IAPA have also undertaken various types of public projects such as commercial complexes, hotels, libraries, museums, exhibition halls, theaters, visitor centers, science centers, cultural centers, underground spaces, as well as different types of landscape and interior design project.

IAPA has been honored with numerous international awards for its outstanding design quality. These accolades include selected as a finalist for the World Architecture Festival, winning the Best of Best Award of Iconic Awards, the Gold Award of A' Design Awards, the German Design Award (GDA), the International Architecture Awards, the honorable mention of ARCASIA Architecture Awards, the RIBA Competition Winning Award, the Merit Award of Gold Nugget Awards, the BLT Design Awards winner, the Silver Award of A&D Design Awards, the LOOP Design Awards, the Paris DNA Design Awards, the Architecture Master Prize Awards, the Gold Winner of MUSE Design Awards, the Global Design News – Future Architecture Award, the AHLA Asian Landscape Award, the ELA International Landscape Award, the China Yuanye Cup Urban Design Award, and the Guangzhou Excellent Engineering Design First Prize, among others.

IAPA SINCE 1998 **URBAN PLANNING** **ARCHITECTURE** **LANDSCAPE DESIGN** **INTERIOR DESIGN** **HERITAGE PRESERVATION**

Sydney, Australia

6 Old Sydney Road, Seaforth NSW 2092, Australia

GuangZhou, China

6th Floor, Block A, Poly Zhongyu Plaza, No. 626 Tianhe North Road,
Guangzhou City, China

E-MAIL: Info@iapa.net.au

NET :www.iapa.net.au

Architecture Design

GUANGZHOU DAILY GROUP CULTURE CENTER

I A P A P T Y L T D

WINNER'S AWARD IN THE INTERNATIONAL COMPETITION

Newspapers and printing are the two most representative elements in the newspaper industry culture. The overall concept aims to incorporate the characteristics of Guangzhou's Lingnan culture, particularly its water culture, which represents the city's unique features, along with elements closely related to the newspaper industry. The goal is to create a comprehensive architectural complex that is lively, has distinct connotations, and showcases regional cultural characteristics.

In terms of architecture, the design utilizes cantilevered floor slabs and externally-mounted metal sunshades to emphasize the horizontal lines of the entire building, enhancing the sense of floating paper. The ground level utilizes variations in height to create a diverse open space for outdoor terraces. This allows the concept of paper to be fully functional in both the architecture and the landscape, giving it a significant presence.



Project owner: Guangzhou Daily Newspaper Group

Project scale: The total construction area is about 185,000 sqm

Project location: Guangzhou, Guangdong province, China

Design status: Complete project design

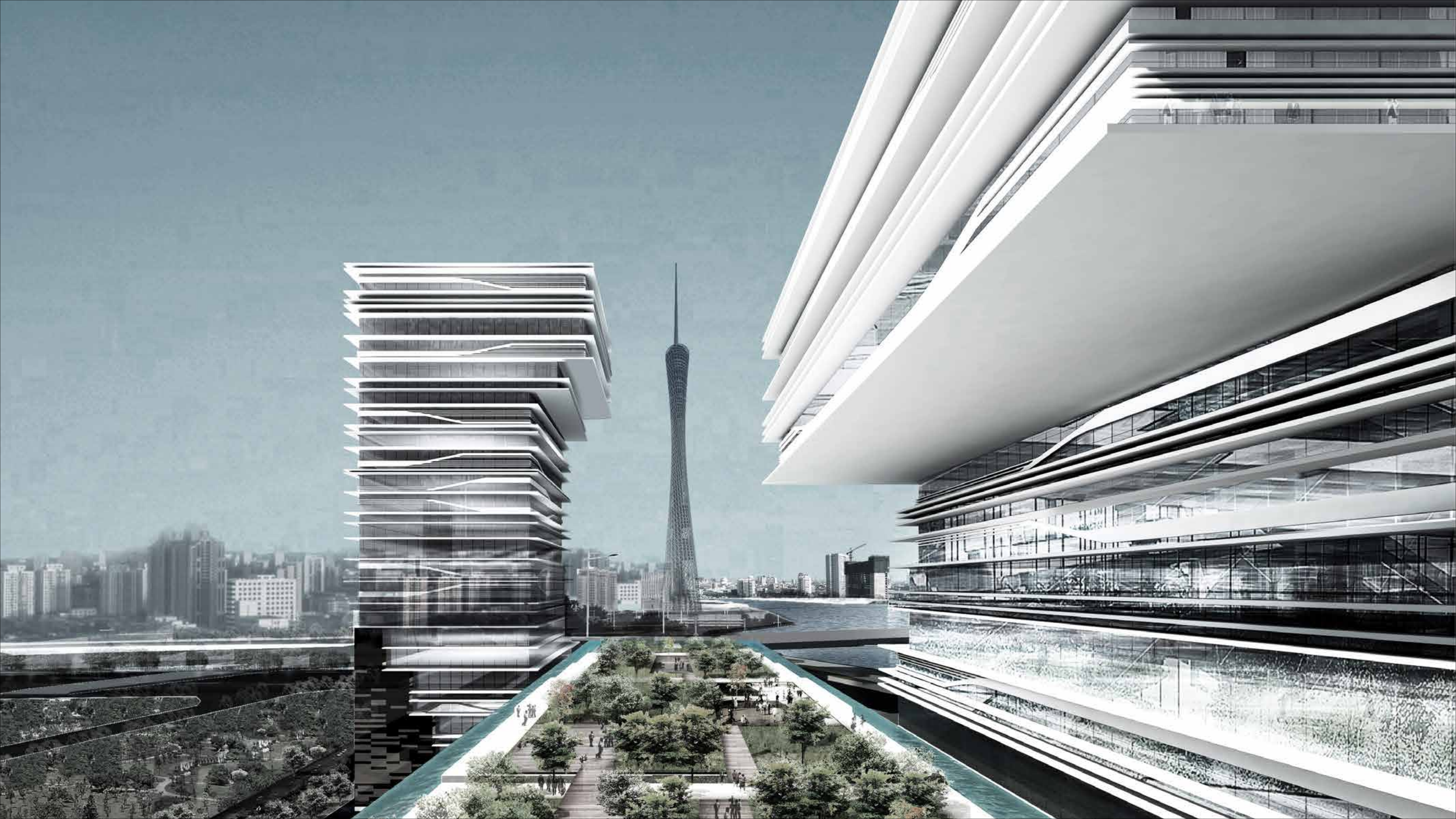

HEYUAN NEW LIBRARY

I A P A P T Y L T D

2019 German Design Award (GDA)

2019 INTERNATIONAL ARCHITECTURE AWARDS

2018 First prize of Guangzhou Excellent Engineering Survey and Design Award

2018 A' Design Awards Winner

2016-2017 Luban Award for Construction Projects

The library is located in the central-northern part of Heyuan Hakka Cultural Park, benefiting from exceptional land and landscape conditions. The three common types of Hakka architecture found in the area are "Tulou," "Weilongwu," and "Wufenglou." Among them, "Wufenglou" is the most prevalent and widely distributed in Hakka settlements, holding a significant position as the origin of Hakka architecture. Its layout and spatial composition reflect reverence for ritual and ethics while carrying rich symbolic meanings. Therefore, it serves as the primary inspiration for our design concept. The proposed design combines the architectural forms of square Tulou and "Weilongwu." The five functional buildings are arranged in response to the sloping terrain, harmonizing with traditional architectural layouts and providing a panoramic view of the beautiful lake scenery.

Project Owner: Heyuan Cultural Broadcasting News Publishing Bureau

Project Scale: The overall planned area is 130 hectares, with a total built-up area of approximately 25,000 sqm.

Project Location: Heyuan, Guangdong province, China.

Project Status: Completed construction.





WANGZHOU AND OCAT XI'AN CULTURAL PAVILION

I A P A P T Y L T D

Located in Fengdong New District, Xi'an, Shaanxi Province, the OCAT Xi'an Pavilion is surrounded by abundant supporting resources. Nearby attractions such as Happy Valley, Shijingli, Fenghe Wetland Park, Fengdong Agricultural Expo Park, Kunming Lake, and the Haokeng Site, a large-scale heritage site, collectively form a regional cultural and tourism cluster.

In our vision, the OCAT Xi'an Pavilion is not only a building that carries the historical and cultural significance of the "Zhou" dynasty but also a showcase of contemporary art and culture. The overall architectural layout is square-shaped, featuring a sleek and modern facade. Drawing inspiration from the architecture of the Zhou dynasty, the building conceptually represents a historical monument situated on a grassy slope, symbolizing a reflection on the "Zhou" historical and cultural heritage.



UNICAMP EXPLORATORY SCIENCE MUSEUM

I A P A P T Y L T D

The new exploratory science museum for Unicamp invites all people to take a tour in the world of technology. The building materials along with the lighting and ventilation systems represent environmentally sustainable low-tech architecture. The water running along the facades adds an playful element to the garden landscape and contributes to the cooling system of the building.



Project Location: Brazil
Project status : Design completed

ICELAND BEER SPA

I A P A P T Y L T D

In the remote Myvatn region of Iceland, nature has created awe-inspiring surface wonders - Skútustaðagígar Craters. SEL Hotel and its upcoming Beer SPA project are located right next to these "wonders." "Our design attempts to break through the traditional form of surrounding buildings and integrate into the site environment as a " LUMINOUS CRATER" responding to and deepening the special impression left by Skútustaðagígar Crater. At the same time, it fully utilizes Iceland's vast natural charm to attract tourists from all over the world to this BEER SPA at the end of the world, to experience the unique micro-tipsy of Mývatn Öl together.

Project scale: Total floor area of 550 sqm
Project location: Iceland
Project status : Complete project design



GUANGZHOU PEAR RIVER BEER MANSION AND HOTEL COMPLEX

I A P A P T Y L T D

WINNER'S AWARD IN THE INTERNATIONAL COMPETITION

Extracting key elements from the historical events and timeline of the Pearl Beer Factory, the spatial re-creation aims to evoke the special memories of the factory buildings for the public. Simultaneously, focusing on the theme of beer brewing, it creates a concept of immersive museum exploration. By utilizing the existing preserved industrial buildings, the brewing process is integrated to reshape and redefine their functions, resulting in themed commercial spaces related to brewing culture. The immersive experience follows a backward journey from the final product of beer to the original barley fields.

The building facades feature rhythmic light-colored forms, distinguishing them from the modern glass curtain walls of the surrounding high-rises, presenting a more approachable demeanor. The consolidation of architectural volumes and the simplified rationality in form treatment are considerations

Project Owner: Guangzhou Pear Beer Co., Ltd.
Project Scale: 180,000 sqm of construction area
Project Location: Guangzhou, Guangdong province, China
Project Status : Currently under construction



THE PAVILION AND PARK IN GUANGZHOU

I A P A P T Y L T D

WINNER'S AWARD IN THE INTERNATIONAL COMPETITION

The Pavilion And Park Project is located on the north side of Haizhu Lake Wetland Park in Guangzhou, adjacent to a vast orchard in the east, boasting a favorable ecological environment. It serves as a crucial node in the southern section of Guangzhou's new urban axis, comprising the Guangzhou Cultural Center and the Lingnan Garden. By incorporating large-scale public buildings into Haizhu Lake Park, our approach is not to showcase grand architectural volumes but to modestly integrate the new buildings into the park's ecological landscape. The design of the public cultural center fully embraces Guangzhou's climatic characteristics, daringly incorporating Lingnan green plants as part of the facade design, creating a symbiotic relationship between the building and the greenery, establishing a new expression of Lingnan architecture.

Project owner: Guangzhou Planning Bureau

Project scale: The total land area is about 34.5 hectares, and the total construction area is 30000 sqm.

Project location: Guangzhou, Guangdong province, China

Project status: Complete project design



GUANGZHOU HAIXINSHA MUSIC MUSEUM PARK

I A P A P T Y L T D

When we started thinking about how to create a world-class landmark new city, a Chinese landscape painting from 600 years ago brought us the initial inspiration. The painting features towering mountains and towering rock peaks, with concise and powerful forms that embody profound traditional Chinese cultural spirit, as well as some modern urban design concepts. In the process of shaping space, we draw inspiration from the concepts of Chinese landscape painting, emphasizing the artistic conception of blending emotions and scenes, and creating a poetic experience that can be explored and traversed.

Project owner: Guangzhou City Urban Investment Property Management Co., Ltd
Project scale: The total planned area is 170000 sqm, with a total construction area of 130000 sqm
Project location: Guangzhou, Guangdong province, China
Design status: Complete project design



XIXIAN NEW DISTRICT JINWAN KECHUANG DISTRICT CIVIC CENTER

I A P A P T Y L T D

THE INTERNATIONAL COMPETITION HONORABLE MENTION

The design concept is based on the idea of "elevated platforms and thick pavilions." By utilizing suspended architectural volumes, the landscape permeates into the urban area from the Feng River, simultaneously releasing the ground floor space. The rooftops are transformed into elevated parks, establishing connections and extending the landscape to the surrounding plots. This creates a vibrant waterfront environment along the Feng River, linking the Feng River Green Belt and the east-west landscape corridors. The three major functional building nodes and landscape nodes form the spatial axis of the plot. The Civic Center comprises a Sports Center, Cultural Center, and Technology Center. These three functions are connected through elevated corridors, allowing for horizontal functional integration and increasing the possibilities for building use. The ground floor space of the entire complex is fully open, vertically linked with each functional area, shaping a 24-hour open and dynamic public community. The rooftop design allows for seamless

Project owner: Shaanxi Xixian New District Development and Construction Management Committee
Project scale: The total land area is about 18.5 hectares, the total construction area is 160 thousand sqm.
Project location: Xi 'an, Shaanxi province, China
Design status: Complete project design





NEW MUSEUM OF YICHANG ARCHIVES

I A P A P T Y L T D

"Seeing mountains as mountains and waters as waters; seeing mountains not as mountains and waters not as waters; seeing mountains still as mountains and waters still as waters." This reflects the three stages of life: attachment, emptiness, and tranquility. Moreover, placing this mindset in a bustling city embodies the concept of great seclusion within urban life. The mountains, waters, and city of Yichang evoke this very feeling.

Project owner: Yichang Urban Construction Investment Holding Group
Project scale: Land Area 10,043.52 m²
Project location: Yichang, Hubei province, China
Project status: Completed construction





TAIYUAN YUNZHU LAKE ART HOTEL

I A P A P T Y L T D

2019 ICONIC Design Awards Selection

The design is primarily divided into two parts: the hotel section and the art exhibition section. The hotel guest rooms are located on the upper floors, while other related functional areas are distributed in the podium of the building, strategically placed to take advantage of the lake view on the southwest side. The conference and art area, which has minimal landscape requirements, is arranged on the eastern side of the podium.



Project owner: Yushe County Jingfeng Cultural Tourism Hotel Co., Ltd.

Project scale: Total Planning Area Approximately 14 hectares, Total Construction Area Approximately 60,000 m²

Project location: Taiyuan, Shanxi province, China

Project status: Complete project design



CHANGCHUN JINGYUETAN POLY THEATRE

I A P A P T Y L T D

The design concept is based on the theme of "architecture is frozen music", which metaphorically and prominently highlights the purpose of the building. On the basis of absorbing the essence of traditional culture, the plan will create a comprehensive entertainment building with individuality, fine details and the ability to hold various activities. While emphasizing visual recognition, we are committed to the integration and unity of architecture and landscape.

Project owner: Poly Real Estate (Group) Co., Ltd
Project location: Changchun City, Jilin Province, China
Project scale: Total land area of 50000 square meters, total construction area of 42000 square meters
Project status: Complete project design



ARCHITECTURAL SCHEME OF HAOJING NO. 1 PROJECT

I A P A P T Y L T D

This plan takes the characteristic landform of "Yuan" in the northwest as the starting point, and uses the techniques of land art to create an artistic highland with strong Zongzhou culture; Starting from the distinctive architectural form of the Zhou culture, we aim to create a modern architectural cluster with unique Zhou cultural characteristics; In the form of a "ten finger intersection and mutual infiltration" texture, a centripetal and permeable landscape corridor and open sunken courtyard commercial space are formed, aiming to gather the flow of people from the north and south plots here.



Project owner: Xi'an Fengdong Overseas Chinese Town Development Co., Ltd.
Project scale: Total Land Area 80,700 m²
Project location: Xi'an, Shaanxi province, China
Design status: Complete project design

SHANXI BAILUYUAN CULTURAL INDUSTRY BASE

I A P A P T Y L T D

Against the backdrop of the long history and culture of Bailuyuan, establish a multifunctional cultural and leisure area that integrates radio and television production and broadcasting, film and television drama shooting and production, leisure, entertainment, and catering. Based on the film and television base, extend and improve the industrial chain, achieve diversified and large-scale operations, and form a cultural industry center centered on Bailuyuan and radiating to surrounding areas.

Project owner: Shaanxi Bailuyuan Tourism Culture Development Co., Ltd
Project scale: The total planned area is about 70 hectares, and the total construction area is about 35000 sqm
Project location: Xi'an, Shanxi province, China
Project Status: Completed construction.

HILTON CHONGZHOU IN CHENGDU

I A P A P T Y L T D

The project site is located on the west side of Chengdu, 54 kilometers away from the city center. The natural conditions of the site are superior, with lush forests, continuous mountains, and rivers that are in season. The four seasons are distinct, far from the mundane world, and in a trance, it is as peaceful and leisurely as being in a peach blossom garden. The interaction between river and terrain forms a unique mudflat landform. At the same time, the base is surrounded by water on three sides and has excellent natural resources in the area.

Project owner: Chengdu Longhai Sanlang Tourism Resource Development Co., Ltd
Project location: Chengdu, Sichuan Province, China
Project scale: The planned total construction area is approximately 40000 sqm

BAILUYUAN DARK KNIGHT THEATER

I A P A P T Y L T D

Against the backdrop of the long history and culture of Bailuyuan, establish a multifunctional cultural and leisure area that integrates radio and television production and broadcasting, film and television drama shooting and production, leisure, entertainment, and catering. Based on the film and television base, extend and improve the industrial chain, achieve diversified and large-scale operations, and form a cultural industry center centered on Bailuyuan and radiating to surrounding areas.

Project owner: Shaanxi Bailuyuan Tourism Culture Development Co., Ltd.
Project scale: The total planned area is about 70 hectares, and the total construction area is about 35000 sqm
Project location: Xi'an, Shanxi province, China
Project Status: Completed construction.



THANK YOU



W E B S I T E : W W W . I A P A . N E T . A U